

\$148,950
East

2805 Dunoon

MLS # 395891
Apx 1627 sq. ft.
Apx 2009 taxes \$2758
Year Built 1959

YISD
Scotsdale Elementary
Eastwood Middle
Eastwood High



Like New!

Completely renovated inside.
Beautiful Cabinets, Corian counter-
tops and stainless steel appliances in
kitchen. Beautiful tile work and new
toilets and sinks in the bathrooms.

Features include:

- Wood laminate flooring
- Berber carpet in bedrooms
- All light fixtures updated
- 30 year Roof Shingle replaced in February 2010
- Carport with storage room
- Ready for immediate occupancy

Call me for a tour!

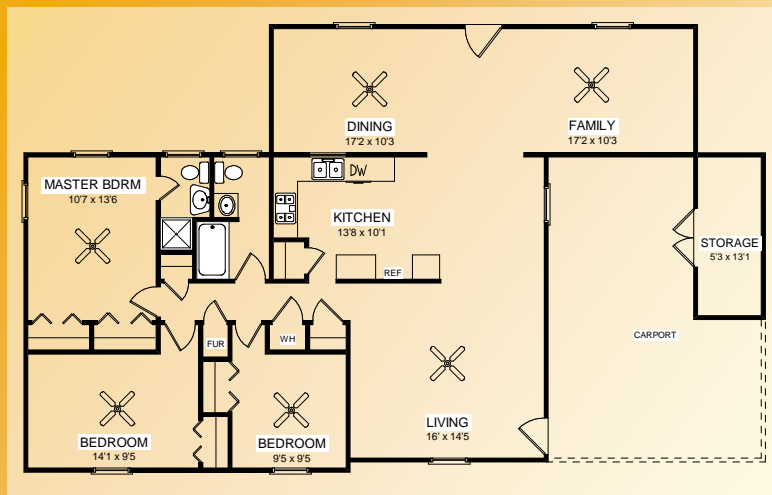

(915) 487-0013
sbart@elp.rr.com



Century 21
The Edge
(915) 772-0553

Jennifer Stroh
(915) 588-2338
www.ahome4u2day.com



Each Office is Independently Owned and Operated. CENTURY 21® is a registered trademark of Century 21 Real Estate Corporation. Information deemed reliable, but should be verified.